



Removal

CAUTION: Inspect the water pump when replacing the timing belt.

NOTE:

- Turn the crankshaft so that No. 1 piston at TDC (see page 6-25).
- Before removing the timing belt, mark its direction of rotation if it to be reused.

1. Disconnect the battery negative terminal first, then the positive terminal.
2. Remove the splash shield.
3. Remove the power steering pump.
 - Do not disconnect the P/S hoses.

8 x 1.25 mm
24 N-m (2.4 kgf-m,
17 lbf-ft)

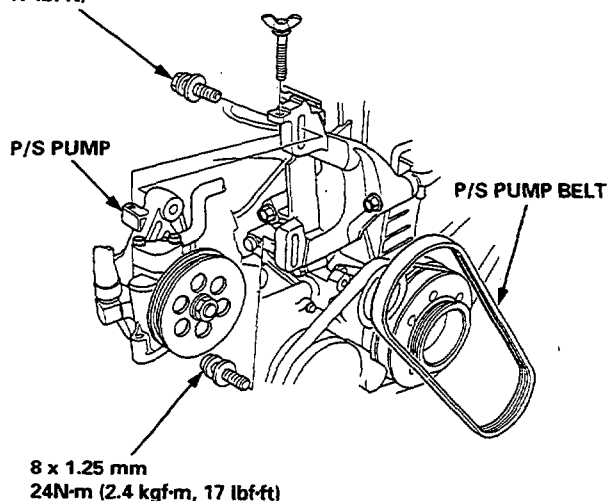

4. Remove the A/C compressor adjust pulley with bracket and the belt (with A/C), then remove the alternator belt.

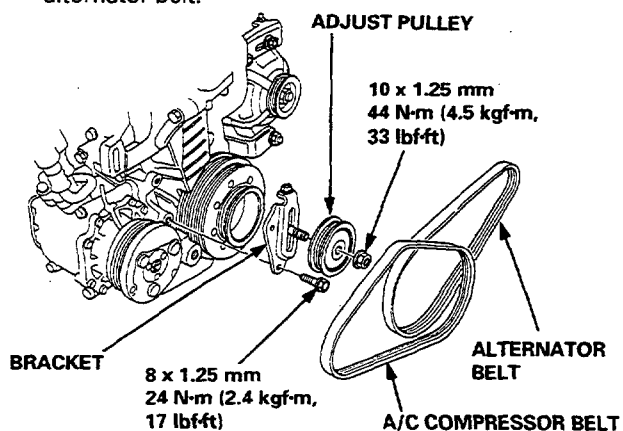

5. Remove the P/S pump bracket.
6. Loosen the alternator adjusting bolt and pivot nut, then remove the belt.

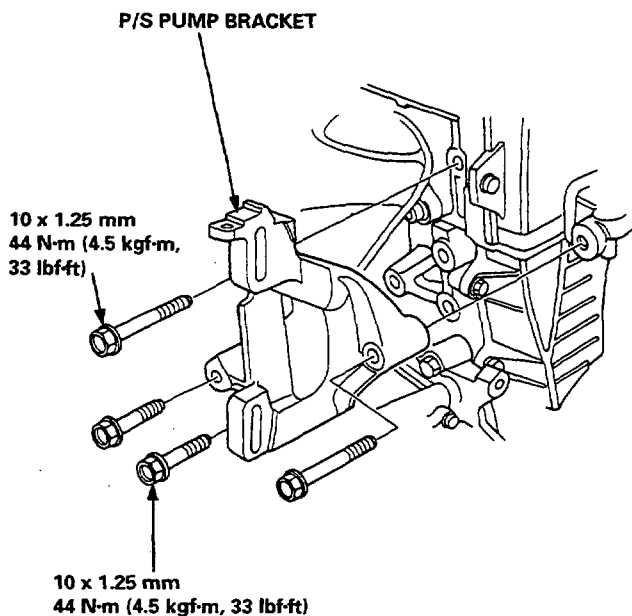

7. Remove the cruise control actuator and the P/S pump tank bracket.
8. Remove the side engine mount.

NOTE:

- Use the jack to support the engine before the side engine mount is removed.
- Make sure to place a cushion between the oil pan and the jack.

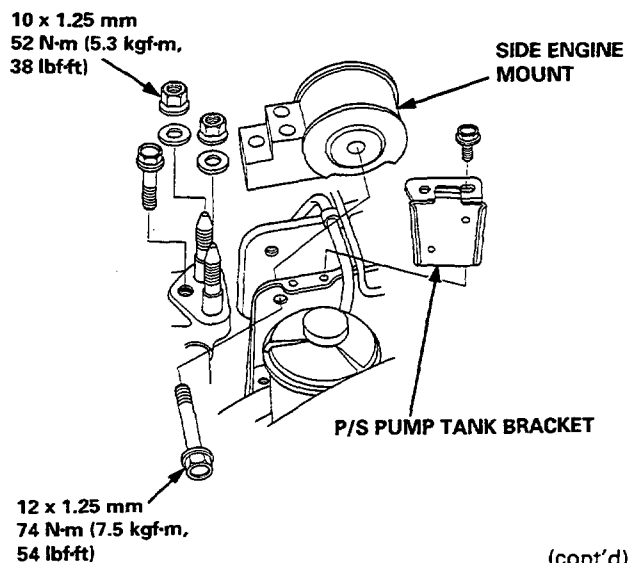

(cont'd)

Timing Belt

Removal (cont'd)

9. Remove the cylinder head cover.

NOTE: Refer to page 6-55 when installing cylinder head cover.

10. Remove the timing belt upper cover.

11. Remove the pulley bolt and crankshaft pulley (see page 6-17).

12. Remove the timing belt lower cover.

NOTE: Do not use the upper and lower covers for storing disassembled items.

13. Loosen the timing belt adjusting bolt 2/3 – 1 turn to release the belt tension.

14. Push the tensioner to release tension from the belt, then retighten the adjusting bolt.

15. Remove the timing belt from the pulleys.

D16Y3, D14A2 engines:

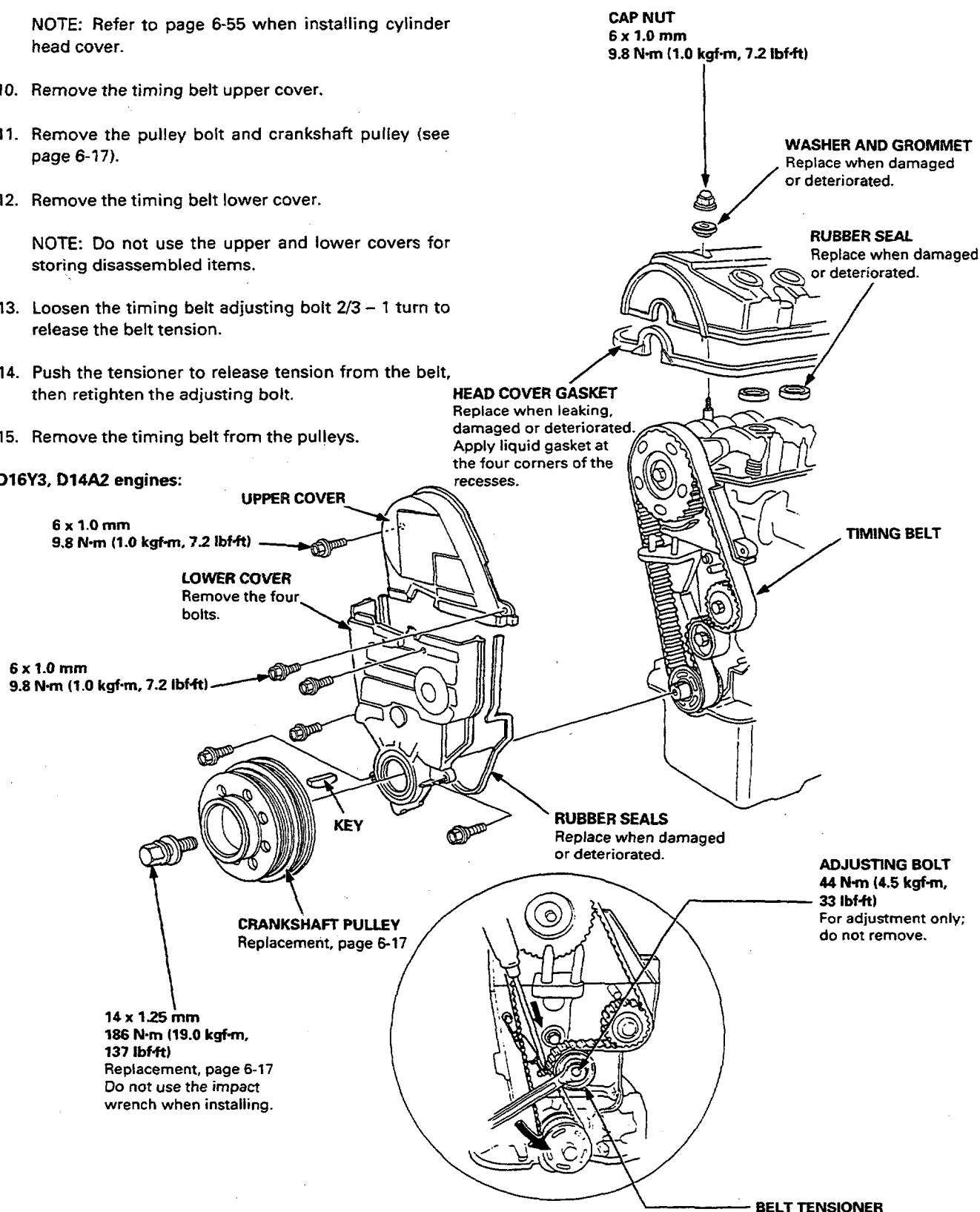



D16Y2, D15Z3 engines:

